

● PACKAGE CONTENTS

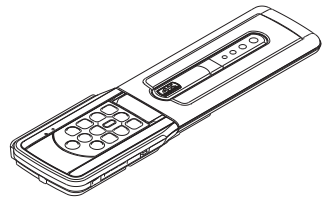

□ MX-P3

※ Caution
Make sure to read the "IMPORTANT SAFEGUARDS" in this guide before using the product.

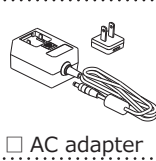

□ AC adapter
(For Japan/
North America only)

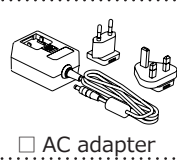

□ AC adapter
(For Europe only)

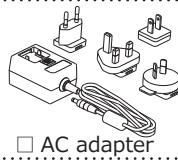

□ AC adapter
(For Asia only)

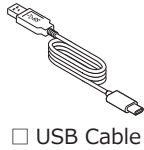

□ USB Cable

- Warranty Card
(For Japan/North America only)
- IMPORTANT SAFEGUARDS
- Quick Start Guide (this book)
- Note (For Europe only)

● PREPARATION

● SETTING UP

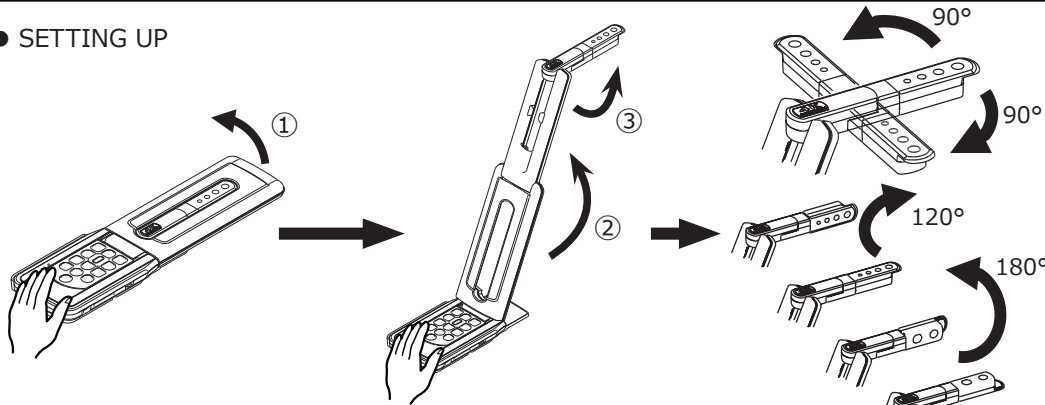

● Connect a display device such as a monitor.

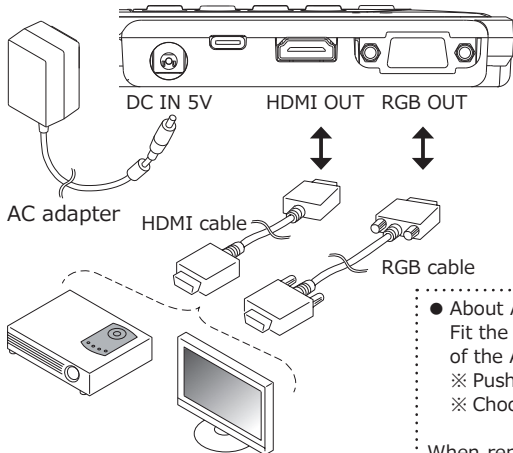

To a Projector or monitor

● Connect the AC adapter.

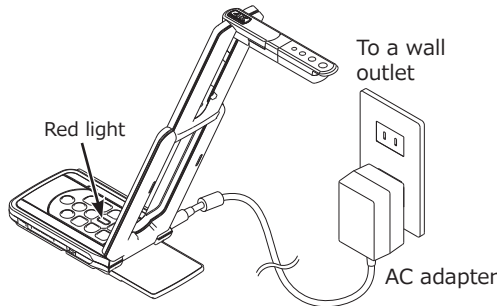

- About AC adapter
Fit the convex part of the plug in the groove of the AC adapter and push it downward.
※ Push it until you hear "click".
※ Choose the correct plug according to the outlet.

When removing the plug from the AC adapter, slide the lock button to the direction of ▼ and pull the plug upward.

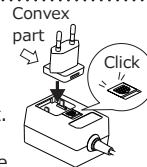

● USING THE PRODUCT

1. Turn on the power.



Press

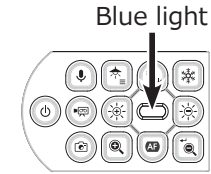

Blue light

2. The camera image appears.

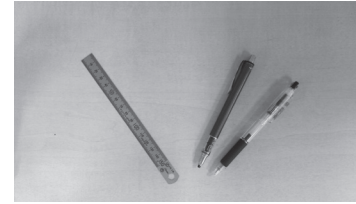

3. Place an object to be displayed under the camera.

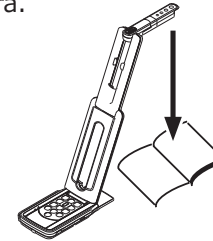

4. Adjust zoom and focus.

Zoom

Enlarge



Press

Shrink



Press

Auto focus (focus adjustment)



Press

5. Turn off the power.



Press

Red light

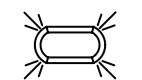

● UVC(USB Video Class)

● Connect to a computer, etc.

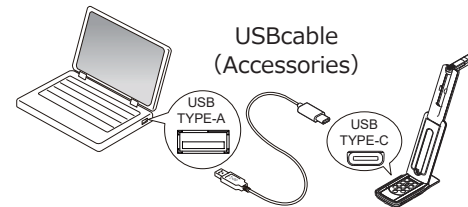

1. Connect the USB cable

Blue light

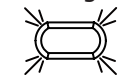

※ The power ⏻ is disabled when power is supplied by USB bus power.

2. Start the UVC application such as a personal computer.

Note

- The frame rate may be decreased depending on the computer used.
- If the bus-powered power supply capacity is insufficient, the operation of this unit may become unstable. In that case, and when outputting USB and HDMI/RGB simultaneously, use the AC adapter to supply power.

● DETAILED USAGE OF THE PRODUCT

For detailed information about the Instruction Manual, refer to the following website:

<https://www.elmoussa.com/>



<https://www.elmoeurope.com/index.php/en/>

